

DTS

DTR



DTS



DTR

DTS: Double-inlet, belt-driven centrifugal fans with axis outlet on both sides and impeller with forward-facing blades

DTR: Double-inlet, belt-driven centrifugal fans with reinforced structure and rigid bridge bearings supported on the structure

Fan:

- Galvanized sheet steel casing
- Impeller with forward-facing blades made from galvanized sheet steel
- DTS Bearing mounted with rubber vibration dampers
- DTS: They are supplied with CPS base stands

Motor:

- Motors with IE-2 efficiency, except for motors with lower powers than 0.75 kW, monophase motors or two-speed motors
- Free axis with permanently greased ball bearings at each end
- Max. air temperature to transport: DTS -20°C.+ 80°C.
DTR: -20°C.+ 110°C.

Finish:

- Anticorrosive galvanized sheet steel.

On request:

- DTS: Motor mounting bracket and SMS belt tensing device can be supplied

Technical characteristics

Model	Speed (r/min)	Installed Power (kW)	Maximum Airflow (m ³ /h)	Air temperature		Approx. weight (kg)
				min. (°C)	máx.	
DTS-7/7	2500	1,1	3700	-20	+80	5,0
DTS-9/9	1800	2,2	6200	-20	+80	9,0
DTS-10/10	1700	3,0	7500	-20	+80	10,5
DTS-12/12	1400	3,0	9500	-20	+80	15,5
DTS-15/15	1000	4,0	14400	-20	+80	24,0
DTS-18/18	800	5,5	23500	-20	+80	33,5
DTR-15/15	1200	5,5	16000	-20	80	28,5
DTR-18/18	1000	7,5	26000	-20	80	40,0
DTR-20/20	1000	11,0	28000	-20	+110	84,0
DTR-22/22	900	15,0	34000	-20	+110	94,0
DTR-25/25	700	15,0	46000	-20	+110	113,0
DTR-30/28	600	18,5	60000	-20	+110	145,0

Dimensions in mm

DTS

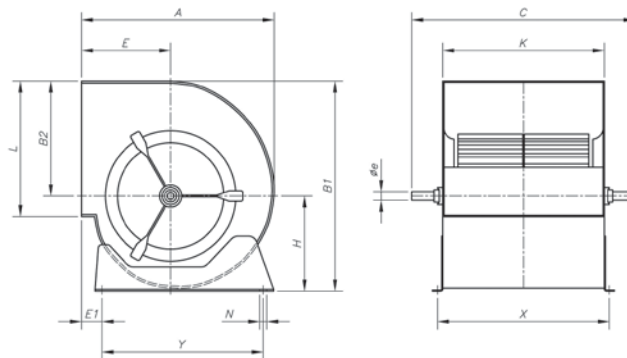

	A	B1	B2	C	E	E1	H	K	L	N	øe	X	Y
DTS-7/7	316	333	189	360	152	64	144	230	208	9x13	20	258	225
DTS-9/9	380	400	218	430	183	78	182	300	263	9x13	20	328	275
DTS-10/10	422	450	246	470	202	73	204	326	292	9x17	20	355	315
DTS-12/12	493	526	290	560	230	82	236	387	345	9x17	25	415	390
DTS-15/15	579	621	348	650	265	92	273	473	404	9x17	25	500	455
DTS-18/18	686	746	415	750	323	82	331	540	482	9x17	25	568	575

DTR

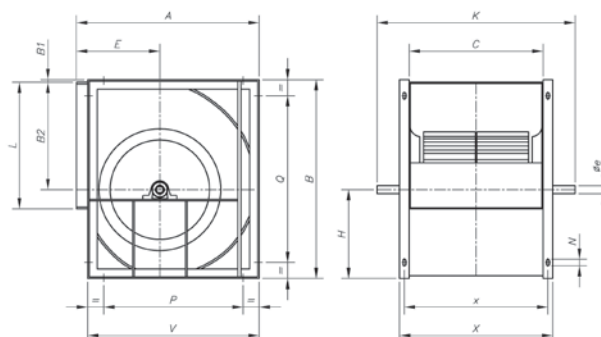

	A	B	B1	B2	C	E	øe	H	K	L	N	P	Q	V	X	x
DTR-15/15	583	632	-	348	473	265	25	284	730	404	9x17	406	406	553	533	505
DTR-18/18	694	756	-	415	540	323	25	341	800	482	9x17	520	608	664	600	572
DTR-20/20	843	963	35	523	603	375	35	405	923	603	13x25	646	811	798	683	643
DTR-22/22	913	1046	35	569	656	400	35	442	976	693	13x25	716	894	868	736	696
DTR-25/25	998	1161	35	642	765	423	35	484	1085	793	13x25	801	1009	953	845	805
DTR-30/28	1206	1400	35	776	888	515	40	589	1208	933	13x25	1009	1248	1161	968	928

Characteristic curves

Q = Airflow in m³/h, m³/s and cfm.
 Pe= Static pressure in mm.w.c., Pa and in wg.

7/7

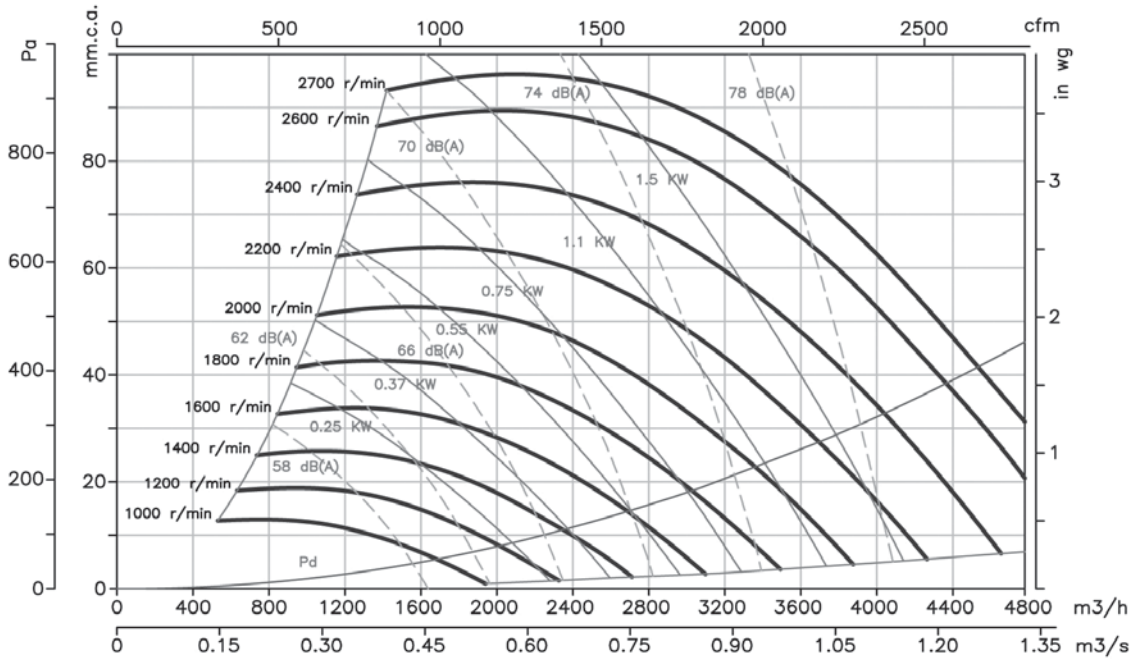

9/9

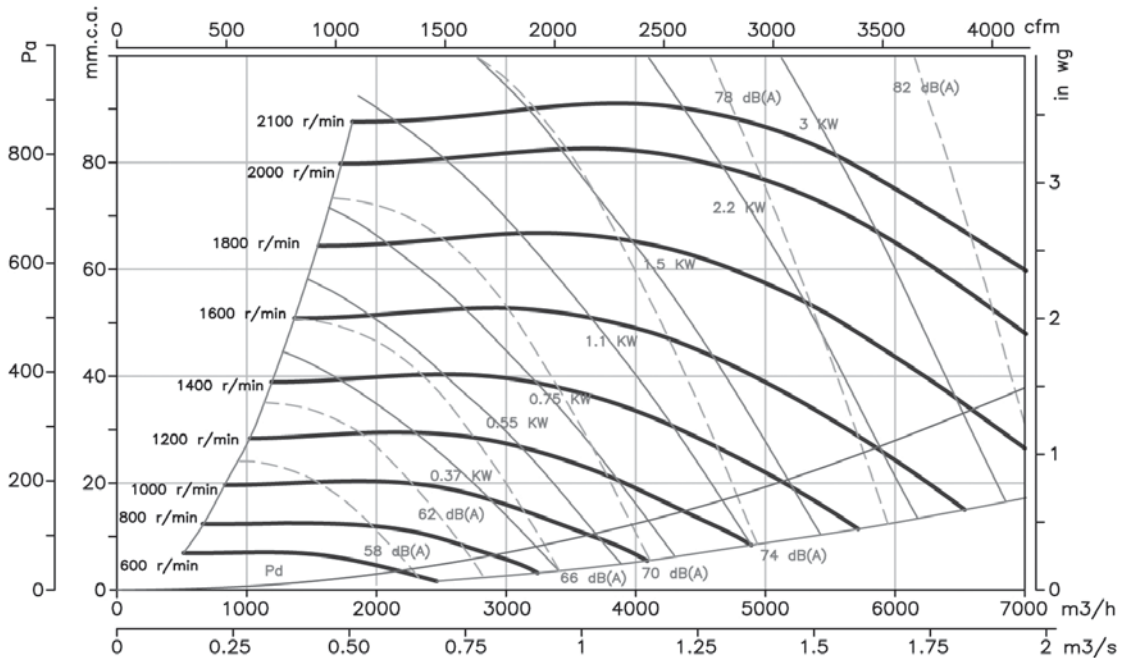

Characteristic curves

Q = Airflow in m³/h, m³/s and cfm.
 Pe = Static pressure in mm.w.c., Pa and in wg.

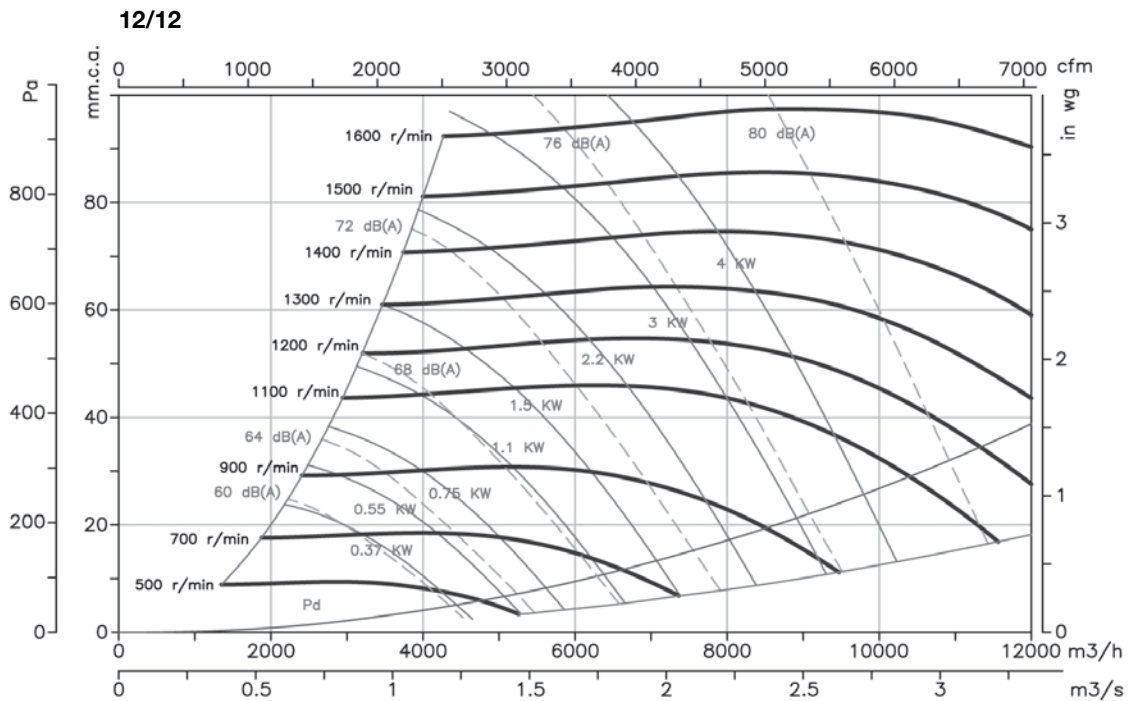
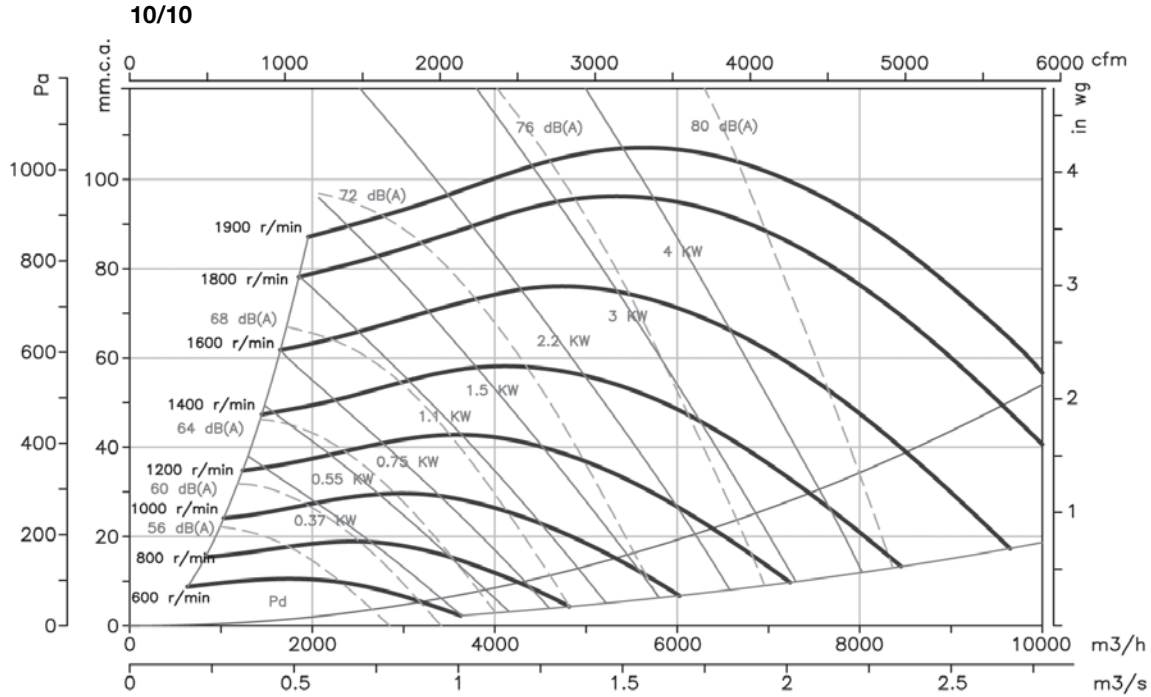

DECORATIVE FANS

WALL MOUNTED FANS

DUCT FANS

DIDW FANS

SISW FANS

ROOF TOP FANS

AXIAL IN LINE FANS

SOMKE FANS

ACCESSORIES

Characteristic curves

Q = Airflow in m³/h, m³/s and cfm.
 Pe = Static pressure in mm.w.c., Pa and in wg.

15/15

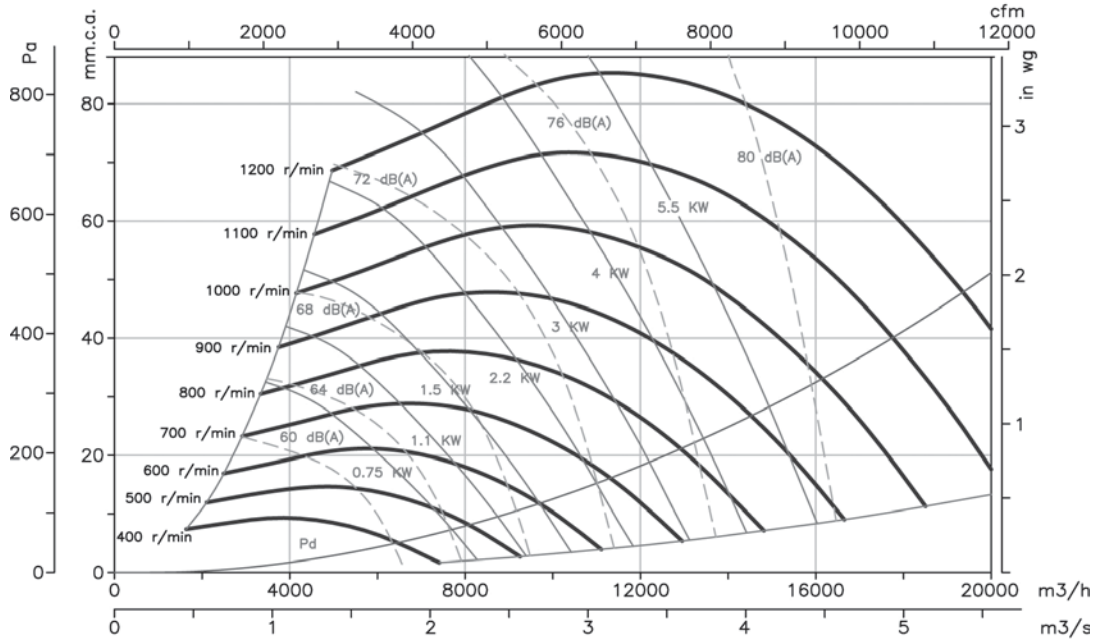

18/18

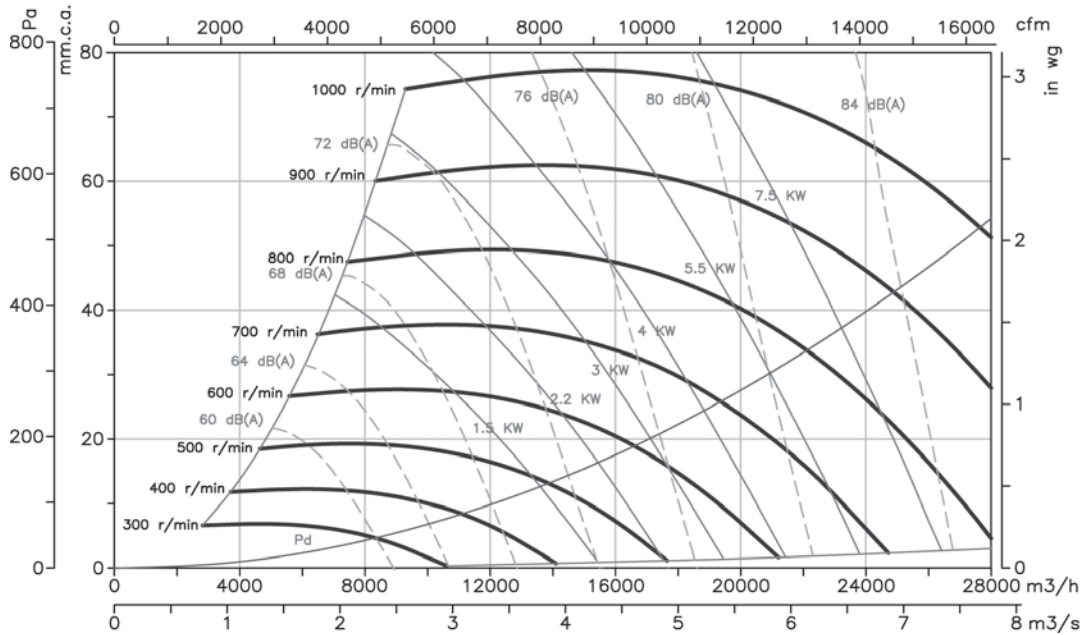

Characteristic curves

Q = Airflow in m³/h, m³/s and cfm.
 Pe = Static pressure in mm.w.c., Pa and in wg.

20/20

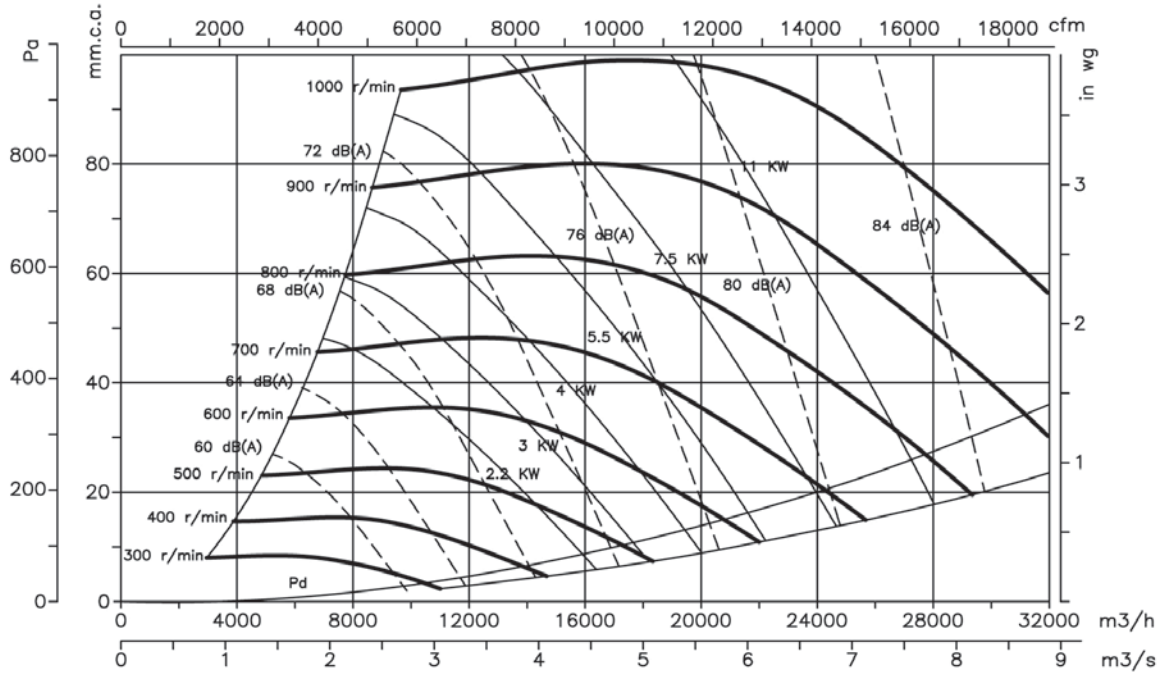

22/22

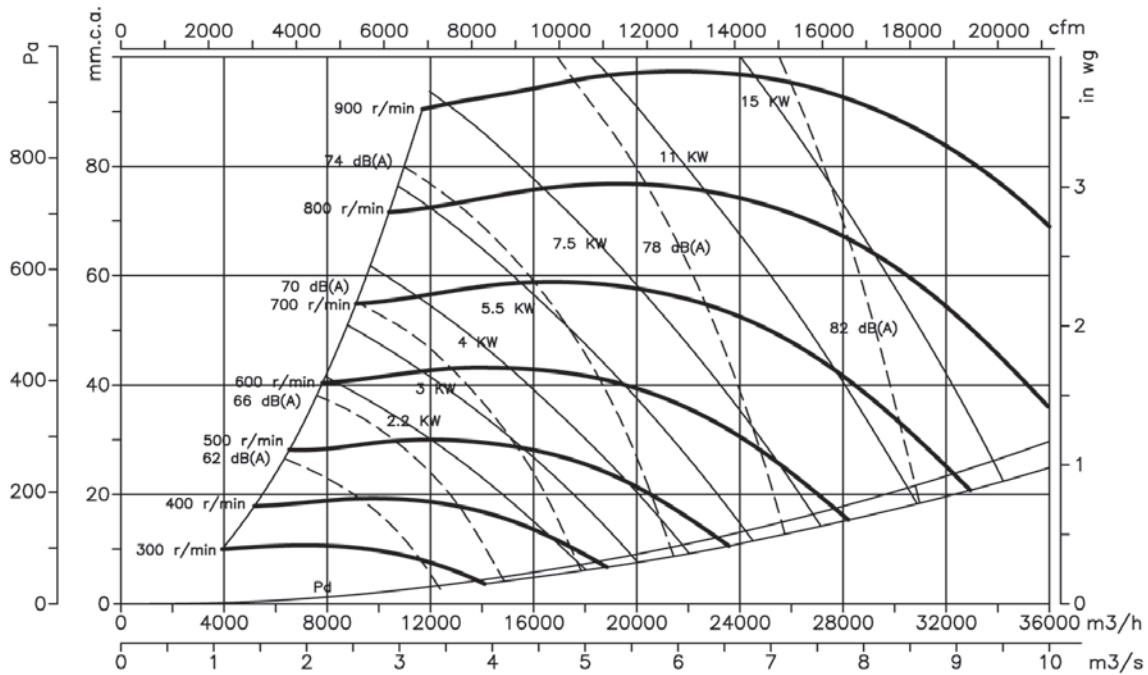

DECORATIVE FANS

WALL MOUNTED FANS

DUCT FANS

DIDW FANS

SISW FANS

ROOF TOP FANS

AXIAL IN LINE FANS

SOMKE FANS

ACCESSORIES

Characteristic curves

Q = Airflow in m³/h, m³/s and cfm.
 Pe = Static pressure in mm.w.c., Pa and in wg.

25/25

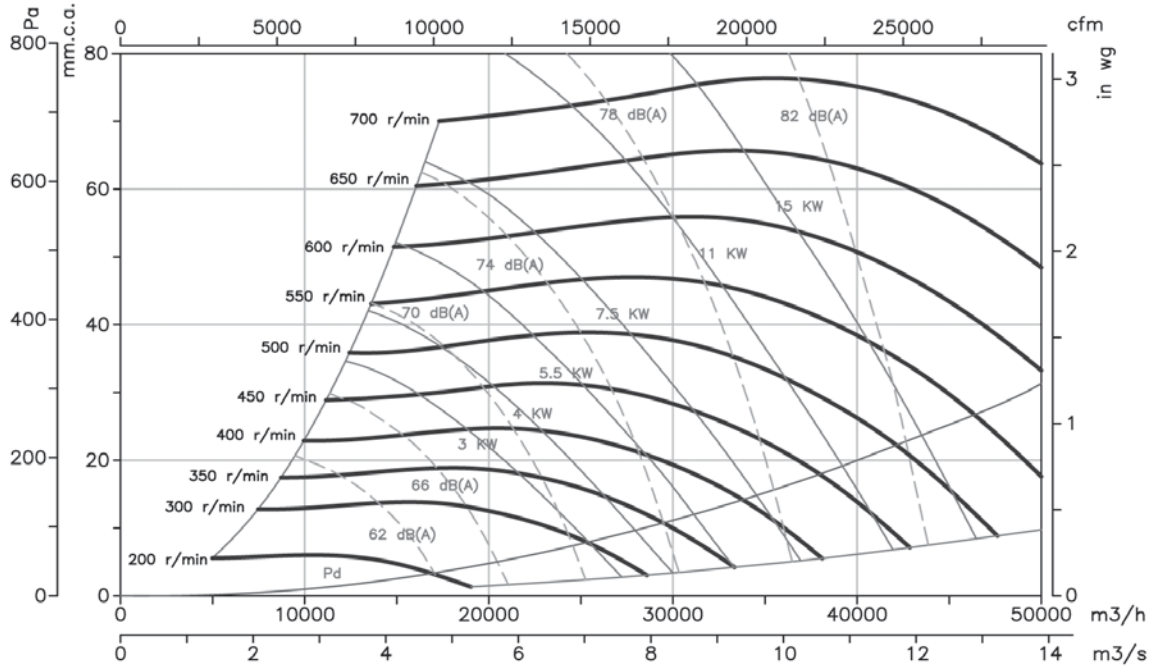

30/28

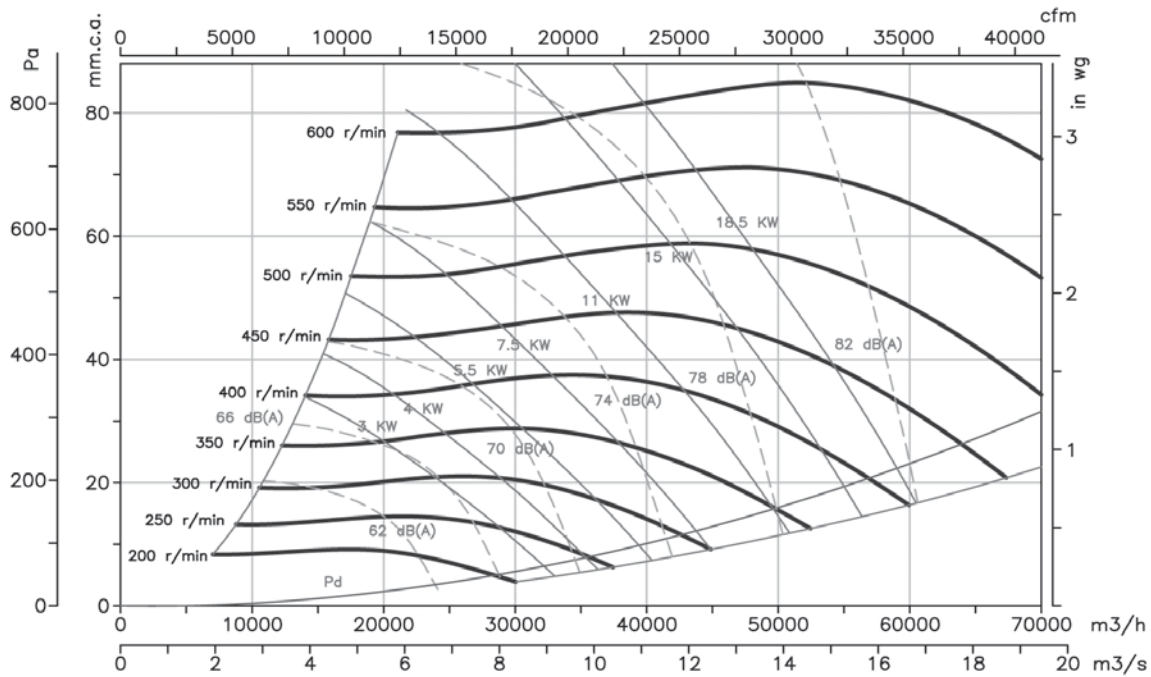

curves according to sisteven standard